

INSTALLATION INSTRUCTIONS

1. ENSURE THE APERTURE IS CLEAN AND FREE OF ANY DUST AND DEBRIS.
2. CUT THE RYANROCK 14050 CAVPACKER TO LENGTH IF REQUIRED.
3. FIX THE CAVPACKER TO THE EDGE OF THE SLAB, 50MM FROM THE TOP OF THE FLOOR.
4. WHERE TWO LENGTHS OF CAVPACKER NEED TO BE JOINED, TIGHTLY BUTT JOINT THEM TOGETHER EDGE TO EDGE, AND SEAL THE JOINT WITH ALUMINIUM FOIL TAPE.
5. CUT THE RYANMESH TO LENGTH IF REQUIRED.
6. POSITION THE RYANMESH INTO PLACE, CENTRALLY WITHIN THE PLANE OF THE CAVPACKER. THE PRE-FORMED FIXING HOLES SHOULD BE PARALLEL TO THE FLOOR / SLAB EDGE.
7. FIX THE RYANMESH USING MINIMUM 6MM X 75MM CONCRETE ANCHORS*, THROUGH ALL PRE-FORMED HOLES.
8. WHERE TWO LENGTHS OF RYANMESH NEED TO BE JOINED, TIGHTLY BUTT JOINT THEM TOGETHER EDGE TO EDGE.
9. JOINTS BETWEEN THE RYANMESH AND THE CAVPACKER SHOULD BE STAGGERED BY MINIMUM 200MM.

*** RYANFIRE RECOMMENDS USING STAINLESS STEEL FIXINGS WHEREVER POSSIBLE.**

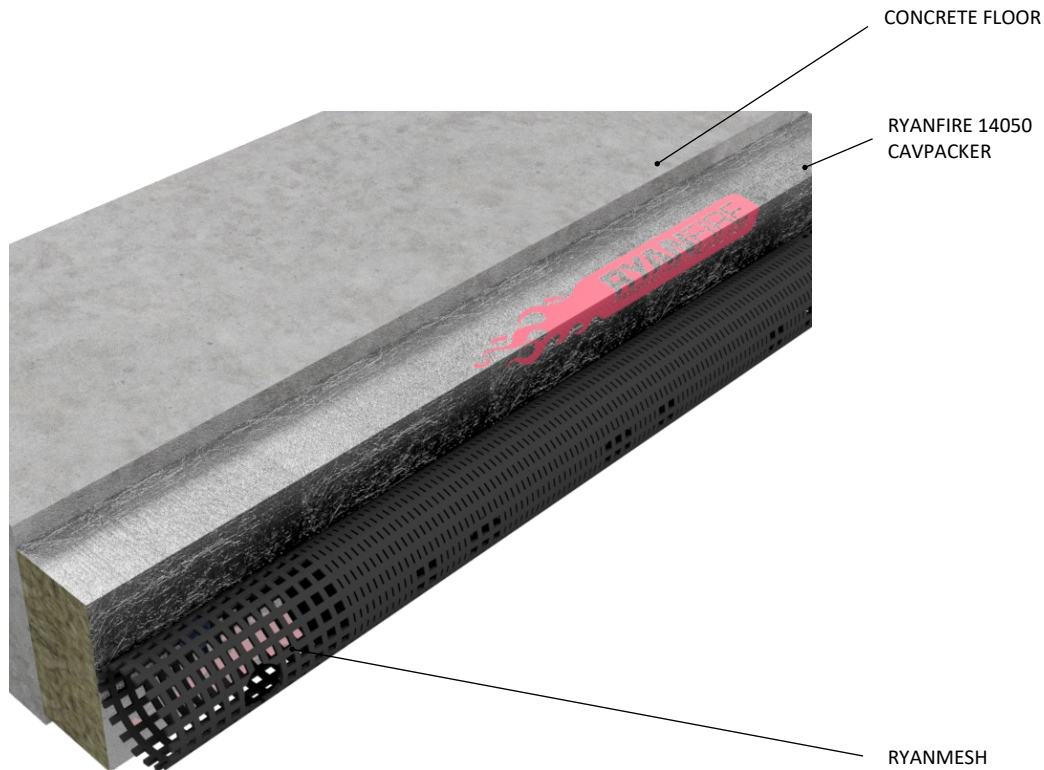

All errors and omissions excepted. The information contained within this drawing is believed to be correct on the date of publication, and is based upon tested and certified solutions. The policy of Ryanfire Products is one of constant improvement. Installers must ensure that they are following the latest published drawings, test evidence and instructions. Whilst Ryanfire Products will endeavour to keep its publications up to date, the accuracy of the information contained within this drawing may be affected by pertinent changes in the law or regulatory requirements and alterations or amendments to the specification of the manufactured products. Terms and conditions of sale apply.

Ryanfire Products owns and has copyright to these drawings. They are to be used only for the purpose for which they were intended and supplied and are not to be sold, transferred or made available for use by a third party. Any misuse of these drawings will result in legal proceedings.

Products: RYANMESH
RYANROCK 14050 CAVPACKER
Approval: AS1530.4:2014 / AS4072.1:2005
Ref: 26SFR00003
BK: 359
ID: A, B

Scenario: Linear gap seal to concrete floor /
Ventilated cavity seal
Construction: 120mm thick concrete floor

Gap size: Up to 100mm

Fire Resistance:	Gap size	FRR
Ryanmesh 60/25	Up to 75mm	-/120/45
Ryanmesh 60/50	Up to 100mm	-/60/15

Ryanmesh is designed for use within cavity systems that have been fire tested and proven to achieve a suitable performance to a relevant local standard and has been deemed suitable for perimeter cladding within the relevant building design code.

Web based drawings are for example only, fire performance of any system is dependant on, but not limited to size of opening, substrate, if penetrations are passing through, type, size and number. Please refer to Ryanfire technical department for detailed and specific fire performance information.



RYANFIRE Technical Support:
info@ryanfire.co.nz - Tel 09 443 0362

Drawing Title
**Ryanmesh & Cavpacker floor seal
Vented cavity - 120mm concrete floor**

Scale: **NTS** Date: **March 2026**

Drawing Number: **V52.18** Rev: **1.0**