

INSTALLATION INSTRUCTIONS

1. ENSURE THE APERTURE IS CLEAN AND FREE OF DUST AND DEBRIS.
2. CUT THE RYANBATT 502 TO THE REQUIRED SIZE AND SHAPE. ENSURE THAT THE BOARD WILL OVERLAP THE APERTURE BY 100MM ON ALL SIDES.
3. CUT THE RYANBATT ACROSS THE SHORTEST DIMENSION INCORPORATING THE MIDPOINT OF THE PENETRATION TO ENABLE THE BOARD TO BE FITTED TIGHTLY AROUND THE ROD.
4. APPLY RYANFIRE BRUSH GRADE TO ALL CUT AND EXPOSED EDGES OF THE 502 BOARD.
5. FIX THE RYANBATT 502 TO THE SURFACE OF THE WALL USING MINIMUM 75MM LONG STEEL SCREWS AND PENNY WASHERS, 50MM FROM EACH EDGE AND NOT EXCEEDING 200MM CENTRES.
6. APPLY A NOMINAL 10MM BEAD OF RYANFIRE MASTIC TO THE JUNCTION BETWEEN THE 502 BOARD AND THE WALL.
7. APPLY RYANFIRE MASTIC TO THE JUNCTION BETWEEN THE ROD AND THE BOARD.
8. REPEAT THIS PROCESS ON THE OPPOSITE SIDE OF THE WALL.

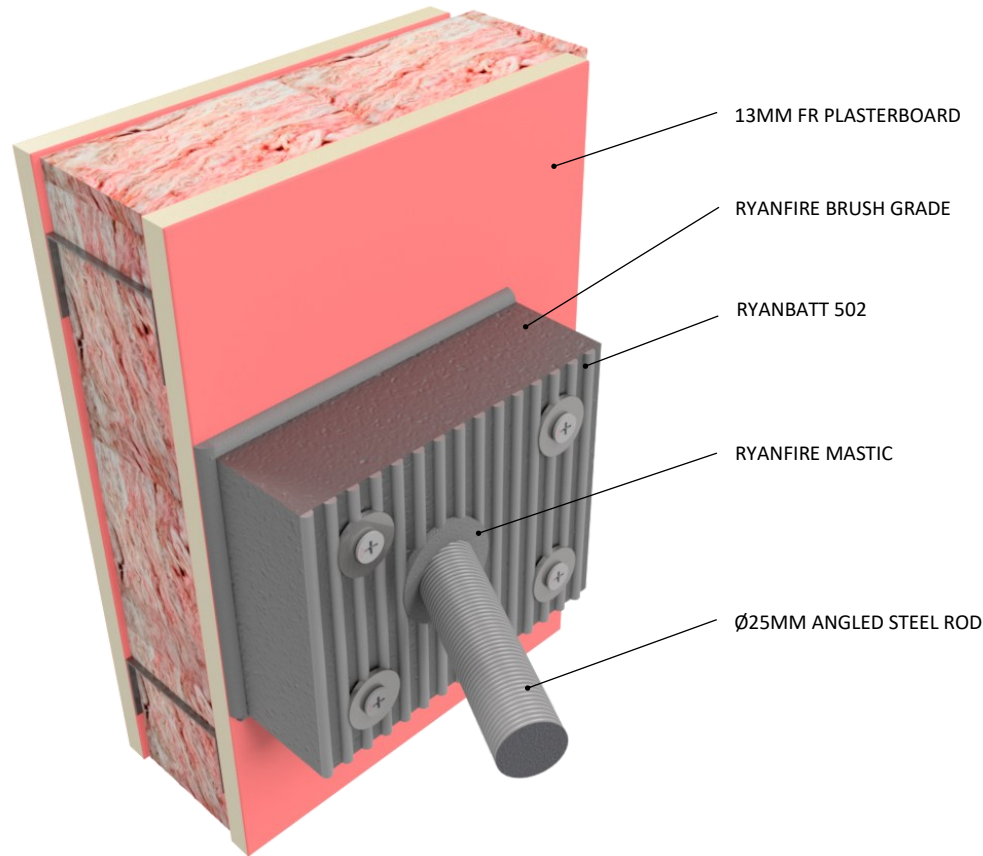

Products:	RYANBATT 502 RYANFIRE MASTIC RYANFIRE BRUSH GRADE MASTIC
Approvals:	AS 1530.4:2014 /AS 4072.1:2005
BK:	346
Ref:	25SFR00043
ID:	C
Scenario:	Penetration seal to steel threaded rod at an angle
Services:	Ø25mm steel threaded rod
Construction:	90mm FR plasterboard / Masonry wall
Fire Integrity:	60 minutes
Fire Insulation:	60 minutes

Web based drawings are for example only. Fire performance of any system is dependant on, but not limited to size of opening, substrate, if penetrations are passing through, type, size and number. Please refer to Ryanfire technical department for detailed and specific fire performance information.



RYANFIRE Technical Support:
info@ryanfire.co.nz - Tel 09 443 0362

Drawing Title
**Ryanbatt 502 to angled steel rod
90mm plasterboard wall**

Scale	Date
NTS	December 2025

Drawing Number	Rev
V1.26	1.0

All errors and omissions excepted. The information contained within this drawing is believed to be correct on the date of publication, and is based upon tested and certified solutions. The policy of Ryanfire Products is one of constant improvement. Installers must ensure that they are following the latest published drawings, test evidence and instructions. Whilst Ryanfire Products will endeavour to keep its publications up to date, the accuracy of the information contained within this drawing may be affected by pertinent changes in the law or regulatory requirements and alterations or amendments to the specification of the manufactured products. Terms and conditions of sale apply.

Ryanfire Products owns and has copyright to these drawings. They are to be used only for the purpose for which they were intended and supplied and are not to be sold, transferred or made available for use by a third party. Any misuse of these drawings will result in legal proceedings.