

## INSTALLATION INSTRUCTIONS

1. ENSURE THE APERTURE IS CLEAN AND FREE OF DUST AND DEBRIS.
2. CUT THE RYANBATT 502 TO FIT TIGHTLY AROUND THE PURLIN AND INTO THE WEBBING. THE BOARD SHOULD OVERLAP THE APERTURE ON ALL SIDES BY MINIMUM 100MM.
3. CUT THE RYANBATT ACROSS THE SHORTEST DIMENSION INCORPORATING THE MIDPOINT OF THE PENETRATION TO ENABLE THE BOARD TO BE FITTED AROUND THE PURLIN.
4. APPLY RYANFIRE MASTIC TO THE SURFACE OF THE BOARD WHERE IT WILL MATE WITH THE WALL.
5. APPLY RYANFIRE BRUSH GRADE MASTIC TO ALL THE EXPOSED & CUT EDGES OF THE RYANBATT.
6. INSTALL THE BOARD ONTO THE WALL AND FIX INTO PLACE USING 75MM PLASTERBOARD SCREWS AND PENNY WASHERS, 50MM FROM THE EDGES OF THE BOARD AND AT CENTRES NOT EXCEEDING 200MM.
7. PACK OUT THE GAPS IN THE WEBBING WITH LAYERS OF SERVOWRAP EXTENDING 600MM FROM THE EDGE OF THE BOARD.
8. WRAP 1 LAYER OF SERVOWRAP AROUND THE PURLIN AND AGAINST THE 502, OVERLAPPING ONTO ITSELF BY 50MM. WRAP A SECOND LAYER AROUND THE PURLIN. THE SERVOWRAP SHOULD EXTEND 600MM ALONG THE PURLIN.
9. SECURE THE SERVOWRAP AROUND THE PURLIN USING STEEL CABLE TIES 50MM FROM EACH END AND ONE NOMINALLY IN THE CENTRE, ON EACH LAYER OF THE WRAP.
10. APPLY A 30X30MM BEAD OF RYANFIRE MASTIC TO THE JOINT BETWEEN THE SERVOWRAP AND THE RYANBATT.
11. APPLY A 5MM BEAD OF RYANFIRE MASTIC TO THE PERIMETER OF THE RYANBATT AND TO ANY JOINTS AND GAPS.
12. SEAL ANY JOINS AND EXPOSED EDGES OF THE SERVOWRAP USING FOIL TAPE.

## ONE WAY SEAL - ASYMMETRICAL

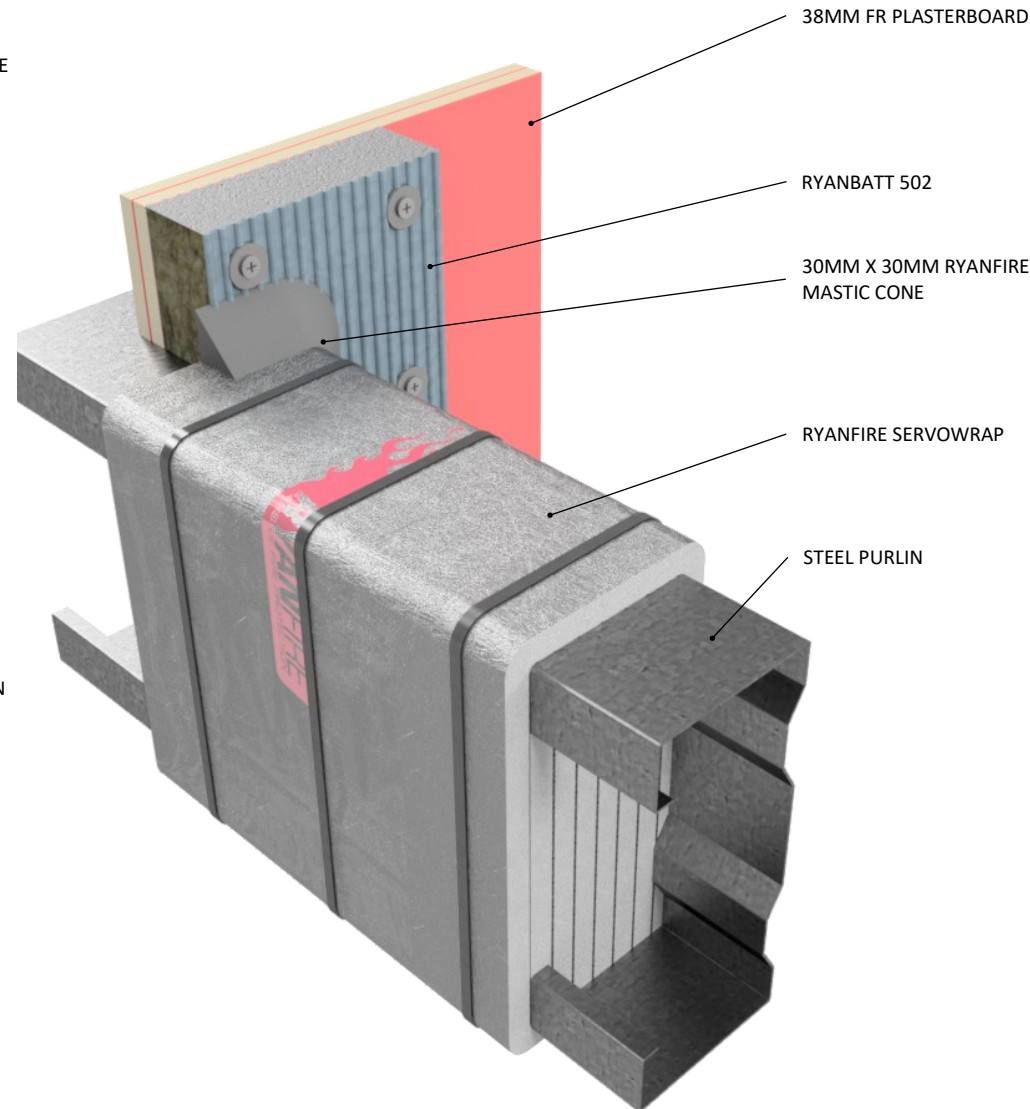

<b>Products:</b>	RYANBATT 502 RYANFIRE MASTIC RYANFIRE SERVOWRAP
<b>Approval:</b>	AS 1530.4:2014/AS 4072.1:2005
<b>BK:</b>	358
<b>Ref:</b>	265FR00002
<b>ID:</b>	C
<b>Scenario:</b>	One way penetration seal to steel purlin
<b>Penetration:</b>	400mm C-purlin
<b>Construction:</b>	122mm one way FR plasterboard wall
<b>Fire Integrity:</b>	120 minutes
<b>Fire Insulation:</b>	120 minutes

Web based drawings are for example only. Fire performance of any system is dependant on, but not limited to, size of opening, substrate, if penetrations are passing through, type, size and number. Please refer to Ryanfire technical department for detailed and specific fire performance information.



RYANFIRE Technical Support:  
info@ryanfire.co.nz - Tel 09 443 0362

Drawing Title  
**Ryanbatt 502 + Servowrap to steel purlin  
122mm one way plasterboard wall**

Scale	NTS	Date	April 2026
Drawing Number	V64.31	Rev	1.0

**All errors and omissions excepted.** The information contained within this drawing is believed to be correct on the date of publication, and is based upon tested and certified solutions. The policy of Ryanfire Products is one of constant improvement. Installers must ensure that they are following the latest published drawings, test evidence and instructions. Whilst Ryanfire Products will endeavour to keep its publications up to date, the accuracy of the information contained within this drawing may be affected by pertinent changes in the law or regulatory requirements and alterations or amendments to the specification of the manufactured products. Terms and conditions of sale apply.

Ryanfire Products owns and has copyright to these drawings. They are to be used only for the purpose for which they were intended and supplied and are not to be sold, transferred or made available for use by a third party. Any misuse of these drawings will result in legal proceedings.