

INSTALLATION INSTRUCTIONS

1. ENSURE THE APERTURE IS CLEAN AND FREE OF DUST AND DEBRIS.
2. CUT THE RYANBATT 502 TO CREATE A 100MM OVERLAP AROUND THE APERTURE. THE APERTURE MUST BE FULLY FRAMED.
3. APPLY RYANFIRE BRUSH GRADE MASTIC TO ALL CUT AND EXPOSED EDGES OF THE RYANBATT.
4. APPLY A THICK BEAD OF RYANFIRE MASTIC ONTO THE PLASTERBOARD, 50MM FROM THE EDGE, AROUND THE PERIMETER OF THE APERTURE. ALTERNATIVEY COAT THE PERIMETER WITH RYANFIRE BRUSH GRADE MASTIC.
5. PLACE THE FIRST LAYER OF RYANBATT OVER THE APERTURE ENSURING THE 100MM OVERLAP ON ALL SIDES. SECURE THE BOARD INTO PLACE WITH 100MM TIMBER SCREWS & PENNY WASHERS, 50MM FROM EACH CORNER OF THE 502, AND AT CENTRES NOT EXCEEDING 200MM. THE SCREWS MUST EMBED INTO THE TIMBER FRAMING.
6. APPLY A THICK BEAD OF RYANFIRE MASTIC ONTO THE FACE OF THE FIRST LAYER OF RYANBATT. ALTERNATIVELY COAT THE FACE WITH BRUSH GRADE MASTIC.
7. PLACE THE SECOND LAYER OF RYANBATT OVER THE FIRST LAYER. SECURE THE BOARD INTO PLACE WITH 125MM TIMBER SCREWS & PENNY WASHERS AT CENTRES NOT EXCEEDING 200MM. OFFSET THE SCREWS TO AVOID CLASHING WITH THE FIRST LAYER OF SCREWS. THE SCREWS MUST EMBED INTO THE TIMBER FRAMING.
8. APPLY A NOMINAL 10MM BEAD OF RYANFIRE MASTIC TO THE JOINT BETWEEN THE PLASTERBOARD AND THE RYANBATT.
9. CLEAN ANY EXCESS MASTIC WITH A DAMP CLOTH.

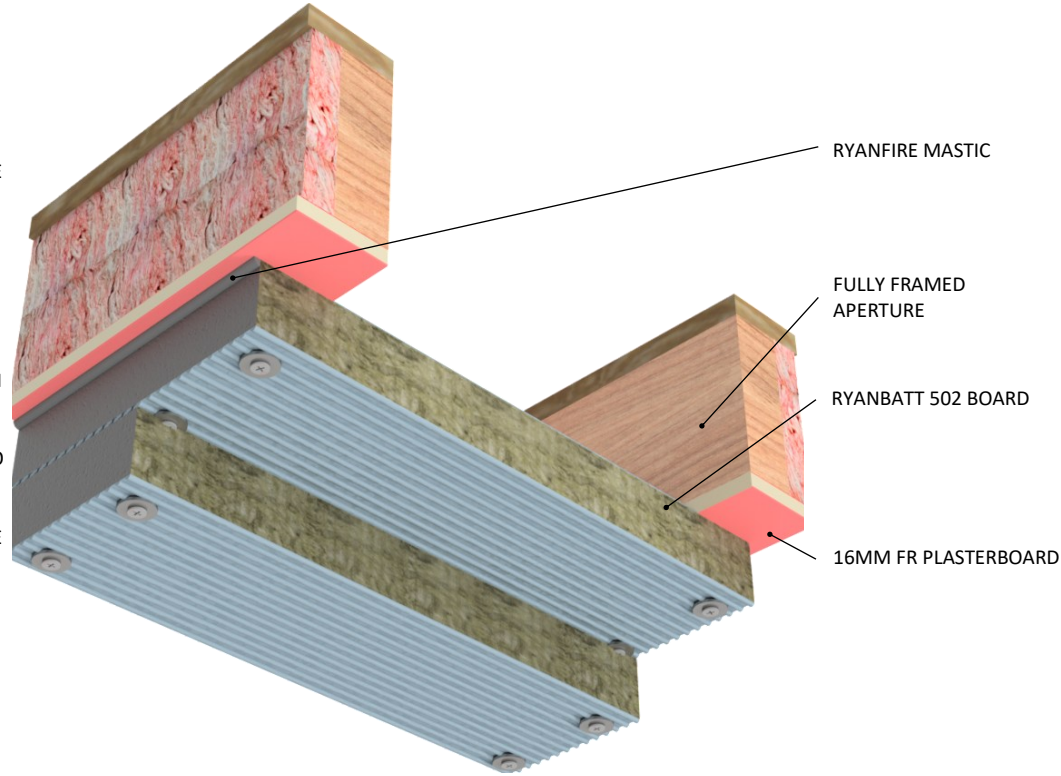

Products: RYANBATT 502
RYANFIRE MASTIC
RYANFIRE BRUSH GRADE MASTIC

Approval: AS 1530.4/AS 4072.1

BK: 330

Ref: 25SFR00021

ID: A

Scenario: Linear ceiling seal

Construction: 16mm FR plasterboard ceiling

Aperture Size: 400mm x 200mm (max) fully framed on all sides

Fire Integrity: 60 minutes

Fire Insulation: 60 minutes

The fire rating may change depending on service penetration performance.

Web based drawings are for example only. Fire performance of any system is dependant on, but not limited to size of opening, substrate, if penetrations are passing through, type, size and number. Please refer to Ryanfire technical department for detailed and specific fire performance information.



RYANFIRE Technical Support:
info@ryanfire.co.nz - Tel 09 443 0362

Drawing Title
Ryanbatt 502 linear ceiling seal
16mm FR plasterboard ceiling

Scale NTS	Date December 2025
---------------------	------------------------------

Drawing Number V53.45	Rev 1.0
---------------------------------	-------------------

All errors and omissions excepted. The information contained within this drawing is believed to be correct on the date of publication, and is based upon tested and certified solutions. The policy of Ryanfire Products is one of constant improvement. Installers must ensure that they are following the latest published drawings, test evidence and instructions. Whilst Ryanfire Products will endeavour to keep its publications up to date, the accuracy of the information contained within this drawing may be affected by pertinent changes in the law or regulatory requirements and alterations or amendments to the specification of the manufactured products. Terms and conditions of sale apply.

Ryanfire Products owns and has copyright to these drawings. They are to be used only for the purpose for which they were intended and supplied and are not to be sold, transferred or made available for use by a third party. Any misuse of these drawings will result in legal proceedings.