

INSTALLATION INSTRUCTIONS

1. ENSURE THE APERTURE IS CLEAN AND FREE OF DUST AND DEBRIS.
2. APPLY A 20MM X 20MM CONE OF RYANFIRE MASTIC AROUND THE JUNCTION BETWEEN THE ROD AND THE PLASTERBOARD.
3. REMOVE ANY EXCESS MASTIC USING A DAMP CLOTH.

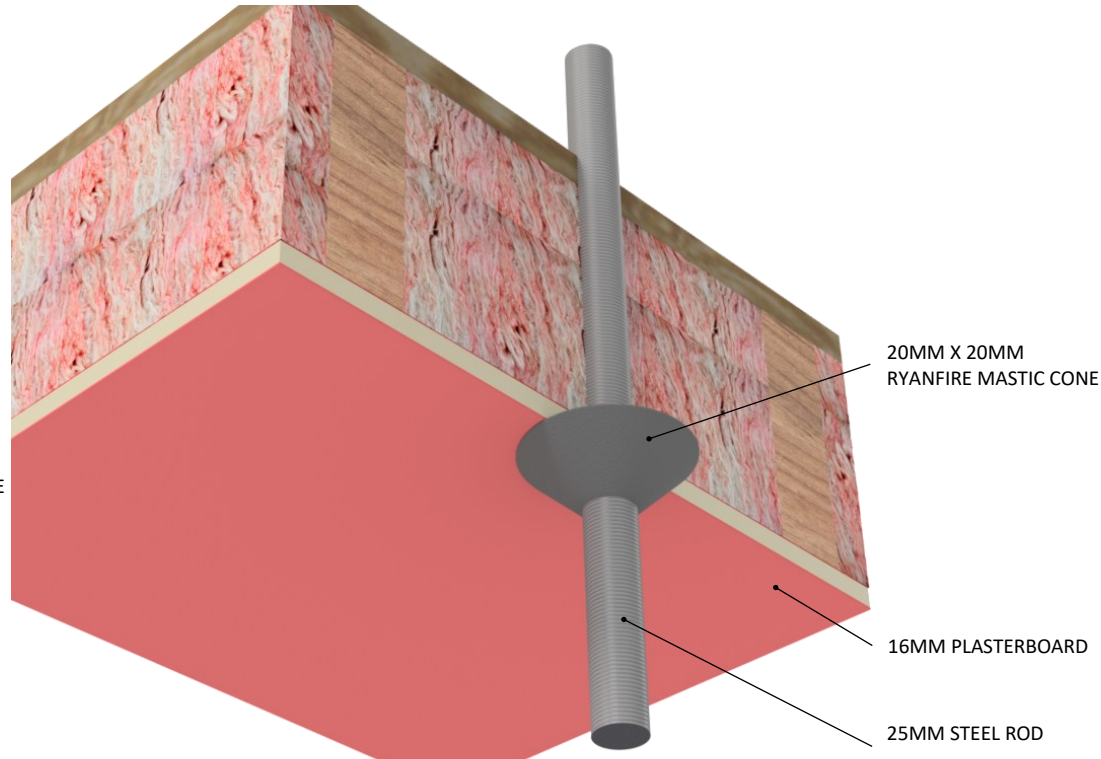

Products:	RYANFIRE MASTIC
Approvals:	AS 1530.4:2014/AS 4072.1:2005
BK:	330
Ref:	25SFR00021
ID:	F
Scenario:	Penetration seal to steel threaded rod
Services:	Ø25mm threaded rod
Construction:	Min 16mm thick FR plasterboard ceiling
Annular Gap:	5 - 8mm
Fire Integrity:	60 minutes
Fire Insulation:	45 minutes

Web based drawings are for example only. Fire performance of any system is dependant on, but not limited to size of opening, substrate, if penetrations are passing through, type, size and number. Please refer to Ryanfire technical department for detailed and specific fire performance information.



RYANFIRE Technical Support:
 info@ryanfire.co.nz - Tel 09 443 0362

Drawing Title
**Ryanfire Mastic to steel threaded rod
 16mm plasterboard ceiling**

Scale	NTS	Date	December 2025
-------	------------	------	----------------------

Drawing Number	V9.29	Rev	1.0
----------------	--------------	-----	------------

All errors and omissions excepted. The information contained within this drawing is believed to be correct on the date of publication, and is based upon tested and certified solutions. The policy of Ryanfire Products is one of constant improvement. Installers must ensure that they are following the latest published drawings, test evidence and instructions. Whilst Ryanfire Products will endeavour to keep its publications up to date, the accuracy of the information contained within this drawing may be affected by pertinent changes in the law or regulatory requirements and alterations or amendments to the specification of the manufactured products. Terms and conditions of sale apply.

Ryanfire Products owns and has copyright to these drawings. They are to be used only for the purpose for which they were intended and supplied and are not to be sold, transferred or made available for use by a third party. Any misuse of these drawings will result in legal proceedings.