

INSTALLATION INSTRUCTIONS

1. ENSURE THE APERTURE IS CLEAN AND FREE OF DEBRIS.
2. CUT THE RYANBATT 802 TO FIT TIGHTLY BETWEEN THE TIMBER FRAMING AND THE DAMPER. JOINS IN THE 802 SHOULD UTILISE A 40MM X 40MM SHIPLAP JOINT.
3. COAT ALL INTERNAL FRAMING WITH RYANFIRE MASTIC BRUSH GRADE.
4. COAT ALL RYANBATT 802 EDGES AND JOINTS OF WITH RYANFIRE BRUSH GRADE OR RYANFIRE MASTIC.
5. FIT THE RYANBATT INTO THE VOID.
6. APPLY A NOMINAL 15MM X 15MM CONE OF RYANFIRE MASTIC TO THE JUNCTION BETWEEN THE DAMPER AND THE RYANBATT, ON BOTH SIDES OF THE PENETRATION.
7. APPLY RYANFIRE MASTIC TO ALL OTHER JUNCTIONS.

THIS DETAIL MAY BE INSTALLED IF YOU ONLY HAVE ACCESS TO ONE SIDE OF THE WALL.

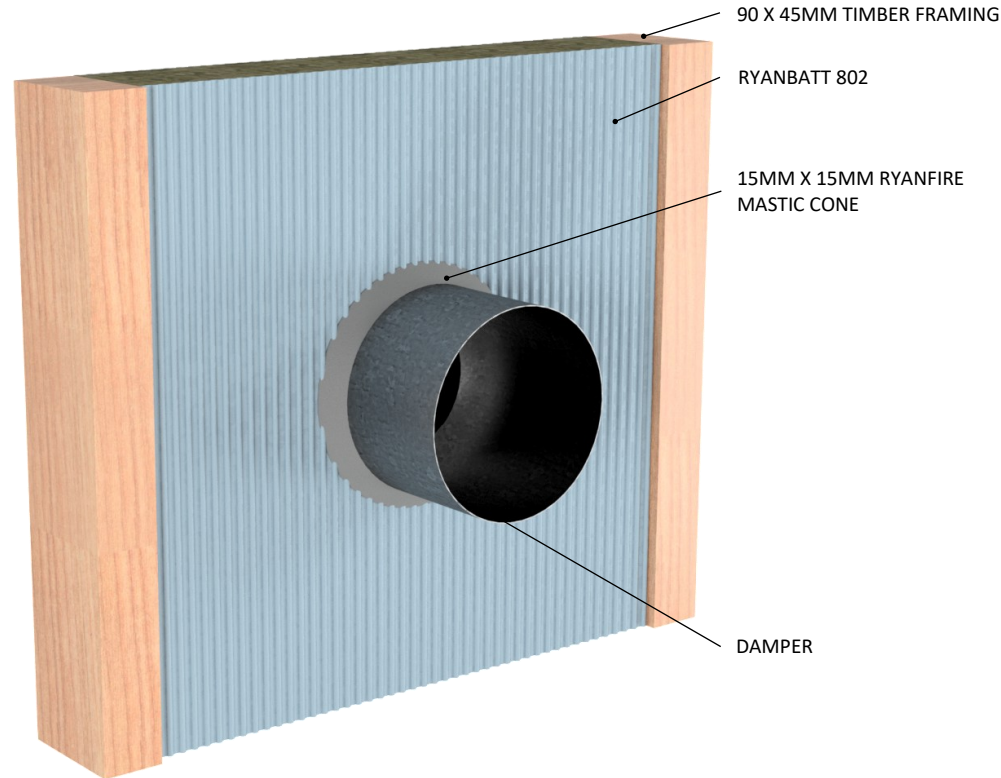

40MM X 40MM SHIPLAP JOINT

Products: RYANBATT 802
RYANFIRE BRUSH GRADE MASTIC
RYANFIRE MASTIC

Approval: AS 1530.4:2014/AS 4072.1:2005

BK: 331

REF: 25SFR00009

ID: C

Scenario: Intumescent Damper in Ryanfire Naked Wall System

Services: Ø150mm damper

Construction: 90mm x 45mm unlined timber framed wall

Fire Integrity: 60 minutes

Fire Insulation: 30 minutes

Web based drawings are for example only. Fire performance of any system is dependant on, but not limited to size of opening, substrate, if penetrations are passing through, type, size and number. Please refer to Ryanfire technical department for detailed and specific fire performance information.



RYANFIRE Technical Support:
info@ryanfire.co.nz - Tel 09 443 0362

Drawing Title
**Ryanfire 90mm Naked Wall System
Intumescent Damper**

Scale NTS	Date February 2026
---------------------	------------------------------

Drawing Number V55.1	Rev 1.0
--------------------------------	-------------------

All errors and omissions excepted. The information contained within this drawing is believed to be correct on the date of publication, and is based upon tested and certified solutions. The policy of Ryanfire Products is one of constant improvement. Installers must ensure that they are following the latest published drawings, test evidence and instructions. Whilst Ryanfire Products will endeavour to keep its publications up to date, the accuracy of the information contained within this drawing may be affected by pertinent changes in the law or regulatory requirements and alterations or amendments to the specification of the manufactured products. Terms and conditions of sale apply.

Ryanfire Products owns and has copyright to these drawings. They are to be used only for the purpose for which they were intended and supplied and are not to be sold, transferred or made available for use by a third party. Any misuse of these drawings will result in legal proceedings.