

INSTALLATION INSTRUCTIONS

1. ENSURE THE APERTURE IS CLEAN AND FREE OF DUST AND DEBRIS.
2. CUT THE RYANBATT 502 TO THE REQUIRED SIZE TO FIT TIGHTLY INTO APERTURE.
3. CUT THE RYANBATT 502 TO FIT TIGHTLY AROUND THE BEAM. CUT A PIECE OF RYANBATT TO FIT INTO THE WEBBING OF THE BEAM.
4. CUT THE RYANBATT ACROSS THE SHORTEST DIMENSION INCORPORATING THE MIDPOINT OF THE PENETRATION TO ENABLE THE BOARD TO BE FITTED INTO THE APERTURE.
5. APPLY RYANFIRE BRUSH GRADE MASTIC TO ALL THE INTERNAL EDGES OF THE APERTURE AND TO ALL THE EXPOSED & CUT EDGES OF THE RYANBATT.
6. INSERT THE RYANBATT INTO THE OPENING, RECESSED BY 25MM WITH THE SURFACE OF THE WALL.
7. APPLY A BEAD OF RYANFIRE MASTIC TO THE JOINT BETWEEN THE RYANBATT & BEAM, TO THE PERIMETER OF THE RYANBATT, AND TO ANY JOINTS AND GAPS.
8. WRAP 1 LAYER OF 300MM WIDE RYANFIRE SERVOWRAP AROUND THE BEAM WITH A 50MM OVERLAP ON THE LONG EDGE. PRESS THE SERVOWRAP UP AGAINST THE SURFACE OF THE RYANBATT. PACK OUT THE GAPS IN THE WEBBING WITH ADDITIONAL LAYERS OF SERVOWRAP.
9. SECURE THE SERVOWRAP AROUND THE BEAM USING STEEL CABLE TIES 50MM FROM EACH END AND ONE NOMINALLY IN THE CENTRE.
10. APPLY A 30X30MM CONE OF RYANFIRE MASTIC TO THE JOINT BETWEEN THE SERVOWRAP AND THE RYANBATT.
11. SEAL ANY EXPOSED EDGES OF THE SERVOWRAP USING FOIL TAPE.
12. REPEAT THIS PROCESS TO THE OPPOSITE SIDE OF THE WALL.

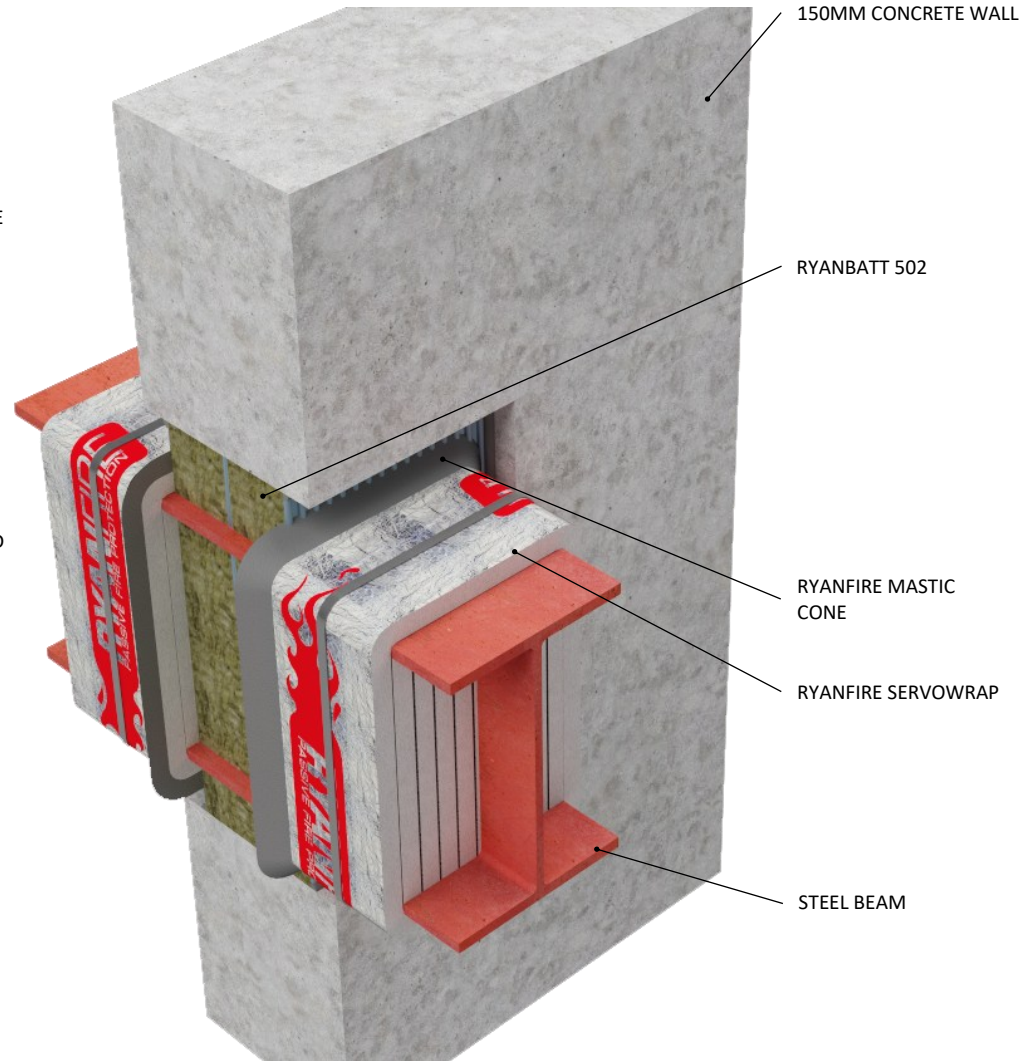

Products:	RYANBATT 502 RYANFIRE MASTIC RYANFIRE SERVOWRAP
Approval:	AS 1530.4/AS 4072.1
BK:	308
Ref:	24SFR00064
ID:	A, B
Scenario:	Penetration seal to steel beams
Penetration:	200, 410 universal beam
Construction:	150mm concrete wall
Fire Integrity:	240 minutes
Fire Insulation:	210 minutes

Web based drawings are for example only. Fire performance of any system is dependant on, but not limited to, size of opening, substrate, if penetrations are passing through, type, size and number. Please refer to Ryanfire technical department for detailed and specific fire performance information.



RYANFIRE Technical Support:
info@ryanfire.co.nz - Tel 09 443 0362

Drawing Title
**Ryanbatt 502 & Servowrap to steel beam
150mm concrete wall**

Scale	Date
NTS	May 2026
Drawing Number	Rev
V64.26	2.0

All errors and omissions excepted. The information contained within this drawing is believed to be correct on the date of publication, and is based upon tested and certified solutions. The policy of Ryanfire Products is one of constant improvement. Installers must ensure that they are following the latest published drawings, test evidence and instructions. Whilst Ryanfire Products will endeavour to keep its publications up to date, the accuracy of the information contained within this drawing may be affected by pertinent changes in the law or regulatory requirements and alterations or amendments to the specification of the manufactured products. Terms and conditions of sale apply.

Ryanfire Products owns and has copyright to these drawings. They are to be used only for the purpose for which they were intended and supplied and are not to be sold, transferred or made available for use by a third party. Any misuse of these drawings will result in legal proceedings.