

INSTALLATION INSTRUCTIONS

1. ENSURE THE APERTURE IS CLEAN AND FREE OF DEBRIS AND LOOSE CEMENT. REMOVE DUST FROM SURFACES REQUIRING INSTALLATION.
2. CUT THE INTUBATT TO THE REQUIRED SIZE AND SHAPE, ENSURING THE INTUBATT WILL OVERLAP THE WALL 75MM AROUND THE OPENING.
3. CUT THE INTUBATT TO TIGHTLY FIT AROUND THE CABLES AND CABLE TRAY.
4. CUT THE INTUBATT ACROSS THE SHORTEST DIMENSION INCORPORATING THE MIDPOINT OF THE CABLE TRAY, TO ENABLE THE INTUBATT TO BE FITTED IN TO THE APERTURE.
5. APPLY INTUMASTIC BRUSH GRADE TO ALL EDGES OF THE INTUBATT ENSURING THAT AN EVEN COVER IS ACHIEVED OVER THE ENTIRE EXPOSED THICKNESS OF THE INTUBATT. THIS SHOULD INCLUDE THE OUTER EDGES OF THE INTUBATT AND THE CUT ACROSS TO ALLOW INSTALLATION OVER THE APERTURE.
6. APPLY INTUMASTIC TO THE BACK OF THE INTUBATT TO PROVIDE A BOND TO THE SURFACE OF THE PLASTERBOARD.
7. APPLY THE INTUBATT OVER THE OPENING.
8. FIX THE PATRESS INTUBATT TO THE WALL USING MINIMUM 75MM LONG STEEL SCREWS AND 25MM DIAMETER STEEL WASHERS. FIXINGS SHOULD NOT EXCEED 50MM FROM ANY EDGE AND NOT EXCEED 200MM CENTRES.
9. APPLY BRUSH GRADE INTUMASTIC TO ALL EXPOSED MINERAL FIBRE.
10. APPLY AN INTUMASTIC FILLET APPROXIMATELY 10MM WIDE TO THE PERIMETER OF THE INTUBATT WHERE IT MEETS THE PLASTERBOARD AND 6MM WIDE AROUND THE CABLE TRAY /CABLES WHERE IT PASSES THROUGH THE INTUBATT. ENSURE THAT ALL GAPS BETWEEN INTUBATT AND THE SURROUNDING EDGES ARE FULLY FILLED UNSING INTUMASTIC.
11. REPAIR ANY DAMAGES TO THE COATING WHICH MAY HAVE OCCURRED DURING INSTALLATION USING BRUSH OR SPRAYING APPLICATION OF INTUMASTIC.
12. REPEAT ITEMS 2 & 10 OF THE ABOVE TO THE OPPOSITE SIDE OF WALL.

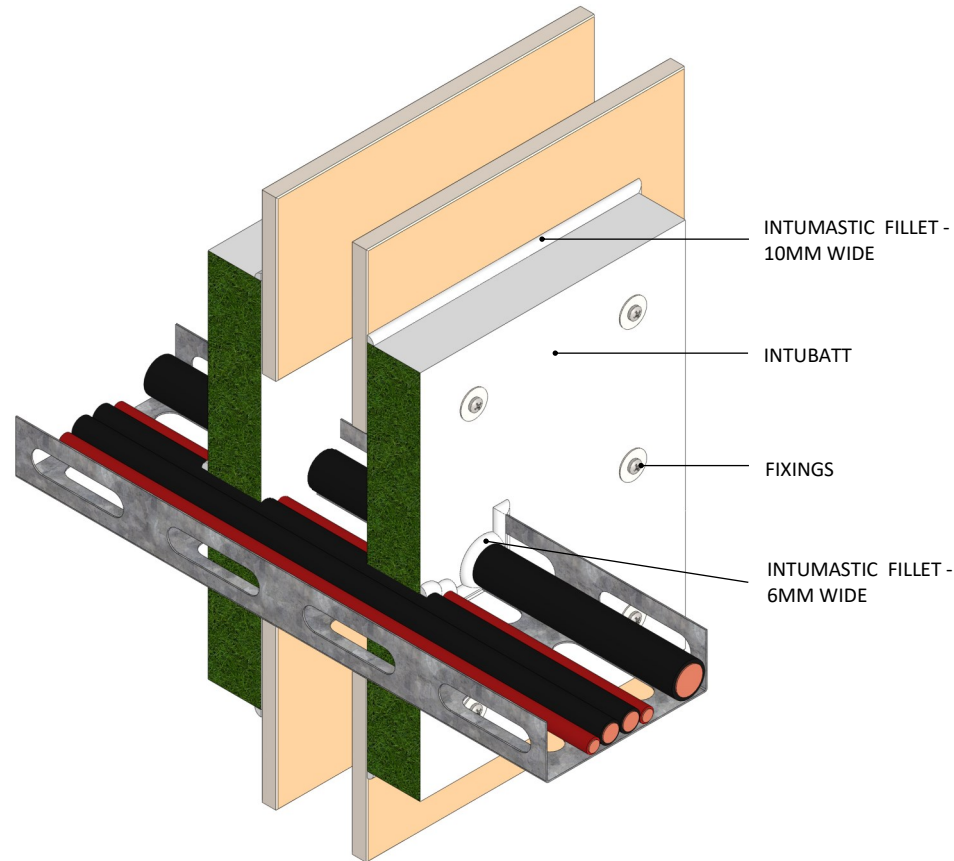

Please note:
Ryanfire Products Ltd owns and has copyright in these drawings. They are to be used only for the purpose for which they were intended and supplied and are not to be sold, transferred or made available for use by a third party.

Any misuse of these drawings will result in legal proceedings.

All errors and omissions excepted - the information contained within this drawing is believed to be correct on the date of publication, and is based upon tested and certified solutions. The policy of **RyanFire Products Ltd** is one of constant improvement. Installers must therefore ensure that they are following the latest published drawings, test evidence and instructions. Whilst **RyanFire Products Ltd** will endeavour to keep its publications up to date, the accuracy of the information contained within this drawing may be affected by pertinent changes in the law or regulatory requirements and alterations or amendments to the specification of the **manufactured** products. Terms and conditions of sale apply.

RYANFIRE Technical Support: info@ryanfire.co.nz - Tel 09 443 0362

Products:	INTUBATT INTUMASTIC
Approval:	AS 1530.4/AS 4072.1
BK:	1
Ref:	35084000 R3.0
ID:	34
Scenario:	Patress penetration seal to cable tray
Services:	Cable tray up to 225mm wide
Construction:	Fire rated gypsum / Masonry wall
Fire Integrity :	60 minutes
Fire Insulation:	60 minutes

Web based drawings are for example only, fire performance of any system is dependant on, but not limited to size of opening, substrate, if penetrations are passing through, type, size and number. Please refer to Ryanfire technical department for detailed and specific fire performance information.



Client

Job Title

Drawing Title

Patress Intubatt to Cable Tray in Fire Rated Gypsum Wall

Scale	NTS	Date	November 2020
Sheet Size	A3	Drawn By	
Drawing Number	V29	Rev	3.0