

## Proposal for exhibitions in the Bridewell Theatre Bar Gallery

### Your proposal

If you're interested in exhibiting, please submit a proposal to John Rankin via e-mail

[john@sbf.org.uk](mailto:john@sbf.org.uk)

Include the following information:

- Your full name and email address.
- A brief description of the proposed exhibition (conceptual theme or curatorial statement no more than 200 words) or artist's statement.
- Include no more than 8 images (each image no more than 250kb file size) of representative work. Please DO NOT just send links to existing portfolios.
- A list of your artwork, numbered to correspond with the images, with title, date, materials used, and the dimensions of the work.
- Résumé of artist(s) and no more than 250 words telling us something about you, what you do and what you aim to achieve. We don't need in-depth analysis or over-complicated explanations. We just want to know what you want to do and why.

### General things

We will endeavor to give you all the help, support and advice you need to make your show a success. There will be certain terms and conditions which we will send you if your proposal is accepted. It outlines what you can expect from us and what we expect from you, in line with our aims and working practice as well practical issues regarding exhibiting your work at the venue and marketing options.

### Exhibition Venue

Bridewell Theatre Bar, Bride Lane, Fleet Street, London EC4Y 8EQ

The Theatre Bar Gallery is a unique space full of Victorian character, situated off Fleet Street in central London. Historically it is part of St. Bride Foundation which was established in 1891 to provide 'social and educational facilities' for the printers and print workers of Fleet Street. The Bridewell Theatre Bar itself was converted in 1999 from the Laundry Room of the adjacent Victorian swimming pool (now part of the Bridewell Theatre stage) and still contains the Victorian washing machine and 'spin dryer'. The gallery project began in 2007.

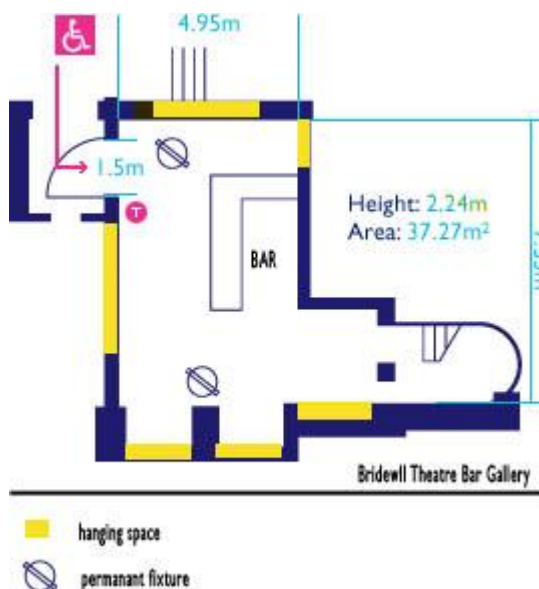

Dimensions of bar / gallery area. Available hanging space highlighted in yellow, a total of approx.12m